

XL COUPLINGS

EXTRA Length for EXTRA Strength

Create greater confidence in your extreme condition pipe connections.

The Fernco XL Coupling is built longer to be stronger, and more durable than any other coupling in the market.



**Longer than
standard
couplings**

Benefits

- Extra Long for pipe alignment problems
- Extra Long to protect against thermal expansion and contraction
- Extra Long to secure pipe from unstable ground and structures
- Extra Long to resist heavy earth loads

Technical Specs

Gasket

- Manufactured to the requirements of:
 - ASTM C 1173
 - ASTM D 5926
 - CSA B602
- Hardness, Shore "A", Inst. ++5 65
- Tensile Strength, Min. psi..... 1000
- Elongation at Rupture, Min. %250
- Tear Strength, Min.....150 in/lb.
- Brittleness Temperature -40°F

Clamps

- 300 Series Stainless Steel
- Installation torque..... 60 in/lb.

Shear Ring

- .012" thick, 300 Series Stainless Steel

Coupling

- Manufactured to the requirements of:
 - ASTM C 1173



XL COUPLINGS

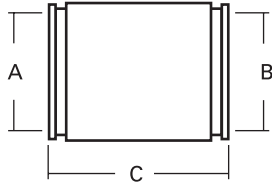

Part Number	Description	A		B		C	
		in.	mm	in.	mm	in.	mm
*1056-1502	1 1/2" CI/Plastic/Steel to 1 1/2" CI/Plastic/Steel	1.90	48	1.90	48	6.88	175
*1056-1502RC	1 1/2" CI/Plastic/Steel to 1 1/2" CI/Plastic/Steel	1.90	48	1.90	48	6.88	175
*1056-222	2" CI/Plastic/Steel to 2" CI/Plastic/Steel	2.38	60	2.38	60	7.75	197
*1056-222RC	2" CI/Plastic/Steel to 2" CI/Plastic/Steel	2.38	60	2.38	60	7.75	197
*1056-332	3" CI/Plastic/Steel to 3" CI/Plastic/Steel	3.40	86	3.40	86	7.75	197
*1056-332RC	3" CI/Plastic/Steel to 3" CI/Plastic/Steel	3.40	86	3.40	86	7.75	197
*1056-442	4" CI/Plastic/Steel to 4" CI/Plastic/Steel	4.40	112	4.40	112	7.75	197
*1056-442RC	4" CI/Plastic/Steel to 4" CI/Plastic/Steel	4.40	112	4.40	112	7.75	197
*1056-443	4" CI/Plastic/Steel to 4" CI/Plastic/Steel	4.40	112	4.40	112	11.63	295
*1056-443RC	4" CI/Plastic/Steel to 4" CI/Plastic/Steel	4.40	112	4.40	112	11.63	295
*1056-552	5" CI/Plastic/Steel to 5" CI/Plastic/Steel	5.51	140	5.51	140	7.85	199
*1056-552RC	5" CI/Plastic/Steel to 5" CI/Plastic/Steel	5.51	140	5.51	140	7.85	199
1056-662	6" CI/Plastic to 6" CI/Plastic	6.63	168	6.63	168	10.00	254
1056-662RC	6" CI/Plastic to 6" CI/Plastic	6.63	168	6.63	168	10.00	254
1056-882	8" CI/Plastic to 8" CI/Plastic	8.64	219	8.64	219	10.00	254
1056-882RC	8" CI/Plastic to 8" CI/Plastic	8.64	219	8.64	219	10.00	254
1056-10102	10" CI/Plastic to 10" CI/Plastic	10.75	273	10.75	273	10.00	254
1056-10102RC	10" CI/Plastic to 10" CI/Plastic	10.75	273	10.75	273	10.00	254
1056-12122	12" CI/Plastic to 12" CI/Plastic	12.75	324	12.75	324	10.00	254
1056-12122RC	12" CI/Plastic to 12" CI/Plastic	12.75	324	12.75	324	10.00	254
1002-442RC	4" Clay to 4" Plastic/CI	5.40	137	4.50	114	10.00	254
1002-662RC	6" Clay to 6" Plastic/CI	7.50	191	6.60	168	10.00	254
1002-882RC	8" Clay to 8" Plastic/CI	9.65	245	8.65	220	10.25	260
1002-10102RC	10" Clay to 10" Plastic/CI	12.50	318	10.50	267	10.25	260
1002-12122RC	12" Clay to 12" Plastic/CI	14.50	368	12.50	318	10.25	260

*Equipped with two clamps per coupling - not including shield.